

FOR LEASE | **Suite 236** Columbia, MO 65201

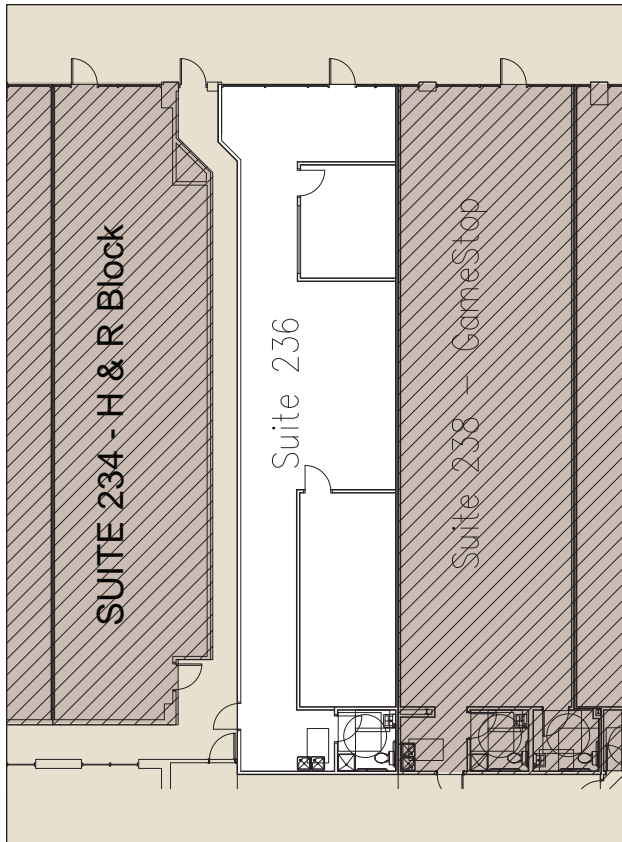

(573) 446-5500
ForumGroup.com



SUITE SUMMARY

- 1,634 square feet
- Broadway & Trimble facing signage
- ADA compliant restroom
- Retail or office use
- Neighboring tenants include Five Guys, GameStop, 2nd Wind Exercise Equipment
- Formerly leased by College Funding Solutions

For leasing information,
contact **Jay Lindner**
jay.lindner@forumgroup.com
(573) 446-5500

The above information is deemed to be accurate however it is subject to errors, omissions and change at any time.

FOR LEASE

Broadway Shops 2703 E. Broadway • Columbia, MO 65201



DEVELOPMENT GROUP

(573) 446-5500

ForumGroup.com



SUMMARY

- 87,000 square feet
- Traffic Count:
Highway 63 - 45,000 VPD
Broadway - 30,000 VPD
- Cotenants include Applebee's, Five Guys, Plato's Closet, Massage Envy, Music Go Round, GameStop and others
- 16,455 Medical Professionals within 3 mile radius
- 1 minute drive from downtown, University of Missouri, Boone Hospital and University Women's & Children's Hospital
- Located at the main entrance to Walmart Supercenter, Sam's Club, Lowe's and Hy-Vee

	Population	Average HH Income	Employment
1 mile	4,755	\$48,176	6,142
3 mile	58,001	\$42,710	50,195
5 mile	111,288	\$54,363	70,171



For leasing information, contact **Jay Lindner**
jay.lindner@forumgroup.com
 (573) 446-5500

The above information is deemed to be accurate however it is subject to errors, omissions and change at any time.